

Cilindro Serie 60 con cerniera Mod. F montata

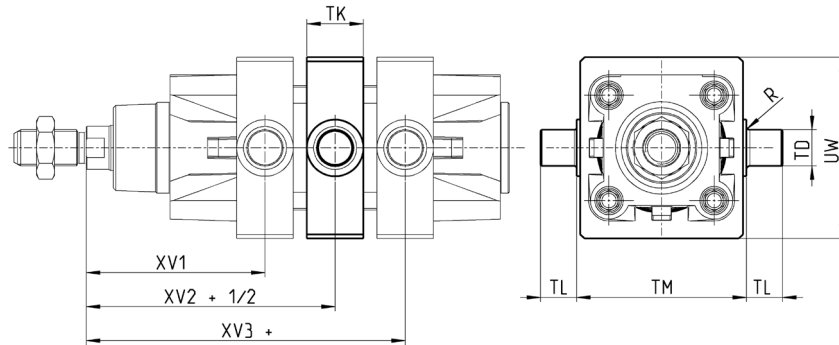

+ = sommare la corsa
 ++ = sommare 2 volte la corsa



| INGOMBRI | | | | | | | | | |
|----------|-------|------|-------|----------|----|---------|----------|-----|-----|
| Ø | XV1 | XV2 | XV3 | TM (h14) | TK | TD (e9) | TL (h14) | UW | R |
| 32 | 62 | 73 | 84 | 50 | 20 | 12 | 12 | 50 | 0.5 |
| 40 | 69 | 82,5 | 96 | 63 | 20 | 16 | 16 | 60 | 1 |
| 50 | 79 | 90 | 101 | 75 | 25 | 16 | 16 | 70 | 1 |
| 63 | 86 | 97,5 | 109 | 90 | 25 | 20 | 20 | 85 | 1 |
| 80 | 97 | 110 | 123 | 110 | 30 | 20 | 20 | 105 | 1 |
| 100 | 104,5 | 120 | 135,5 | 132 | 30 | 25 | 25 | 125 | 1.5 |
| 125 | 123 | 145 | 167 | 160 | 30 | 25 | 25 | 155 | 1.5 |

Ancoraggio a piedini Mod. B

Materiale: Acciaio zincato



La fornitura comprende:
 N° 2 piedini
 N° 4 viti

+ = sommare la corsa

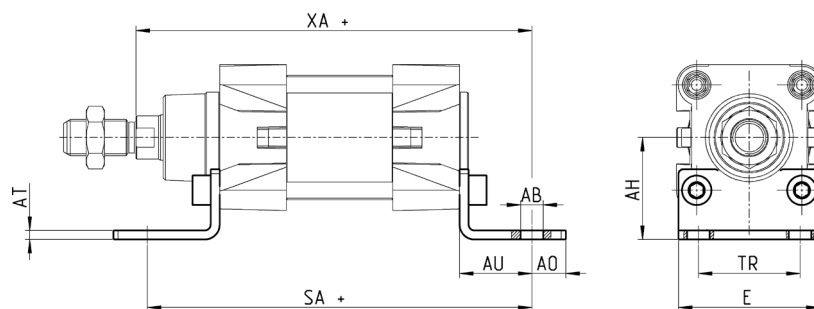

| INGOMBRI | | | | | | | | | | | |
|----------|-----|----|-----|-----|----|-------|------|----|----|----|---------------------|
| Mod. | Ø | AT | SA+ | XA+ | TR | E | AB | AH | AO | AU | coppia di serraggio |
| B-41-32 | 32 | 4 | 142 | 144 | 32 | 45 | 7 | 32 | 11 | 24 | 6 Nm |
| B-41-40 | 40 | 4 | 161 | 163 | 36 | 53,5 | 10 | 36 | 15 | 28 | 6 Nm |
| B-41-50 | 50 | 4 | 170 | 175 | 45 | 62,5 | 10 | 45 | 15 | 32 | 13 Nm |
| B-41-63 | 63 | 5 | 185 | 190 | 50 | 73 | 10 | 50 | 15 | 32 | 13 Nm |
| B-41-80 | 80 | 6 | 210 | 216 | 63 | 92 | 12 | 63 | 20 | 41 | 19 Nm |
| B-41-100 | 100 | 6 | 220 | 230 | 75 | 108,5 | 14,5 | 71 | 25 | 41 | 22 Nm |
| B-41-125 | 125 | 7 | 250 | 270 | 90 | 132 | 16,5 | 90 | 25 | 45 | 26 Nm |