

Codoli maschi con sede conica

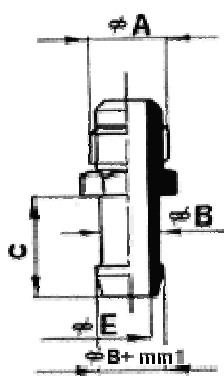

FIG. 1

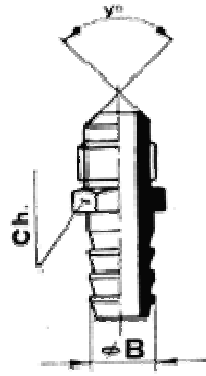

FIG. 2

Filettatura Metrica

CODICE REF.	A FIL.	B	C	E	CH. es	γ°	Fig.
512	12x1,25	6	14	4	17	90	1
277	12x1,5	6	14	4	14	90	1
276	14x1,5	6	14	4	16	90	1
138	16x1,5	9,5	16,5	8	19	90	1
448	20x1,5	13	22,5	10	22	90	2