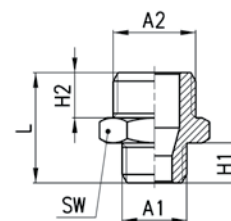
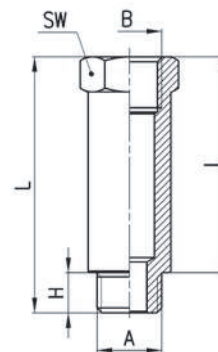
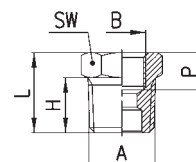

**Raccordi Mod. 2511**

INGOMBRI							
Mod.	A1	A2	H1	H2	L	SW	Peso (g)
<b>2511 M5-1/8</b>	M5	G1/8	4	6	14,5	13	8
<b>2511 1/8-1/4</b>	G1/8	G1/4	6	8	19	17	15
<b>2511 1/8-3/8</b>	G1/8	G3/8	6	9	20	19	19
<b>2511 1/4-3/8</b>	G1/4	G3/8	8	9	22	19	20
<b>2511 1/4-1/2</b>	G1/4	G1/2	8	10	23,5	24	32
<b>2511 3/8-1/2</b>	G3/8	G1/2	9	10	24,5	24	34

**Raccordi Mod. 2525**

INGOMBRI							
Mod.	A	B	H	I	L	SW	Peso (g)
<b>2525 1/8-16</b>	G1/8	G1/8	6	16	22	13	12
<b>2525 1/8-36</b>	G1/8	G1/8	6	36	42	13	24
<b>2525 1/4-27</b>	G1/4	G1/4	8	27	35	17	30
<b>2525 1/4-43</b>	G1/4	G1/4	8	43	51	17	45

**Raccordi Mod. 2530**
**Nuove taglie**

INGOMBRI							
Mod.	A	B	H	L	P	SW	Peso (g)
<b>2530 1/4-1/8</b>	R1/4	G1/8	11	16	6	14	9
<b>2530 3/8-1/8</b>	R3/8	G1/8	11,5	16,5	8,5	17	17
<b>2530 1/2-1/8</b>	R1/2	G1/8	14	19,5	9,5	22	12
<b>2530 3/8-1/4</b>	R3/8	G1/4	11,5	16,5	7	17	34
<b>2530 1/2-1/4</b>	R1/2	G1/4	14	19,5	9,5	22	30
<b>2530 1/2-3/8</b>	R1/2	G3/8	14	19,5	8	22	24
<b>2530 3/4-3/8</b>	R3/4	G3/8	16,5	23	11,5	27	67
<b>2530 3/4-1/2</b>	R3/4	G1/2	16,5	23,5	9,5	27	48
<b>2530 1-1/2</b>	R1	G1/2	19	27	14	34	131