

“U” Bolts - Eye bolts

Art. n° 8034 Cavallotto ad “U”
“U” bolt

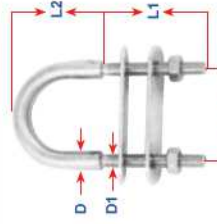

Tipo Type	D1 (mm)	D (mm)	L (mm)	L1 (mm)	L2 (mm)	€/Cad.
A	M 4	5	30	30	32	10 2,80
B	M 5	6	36	48	30	10 2,90
C	M 6	8	36	42	38	10 4,00

A2 / AISI 304

Art. n° 8230 Cavallotto ad “U”
“U” bolt

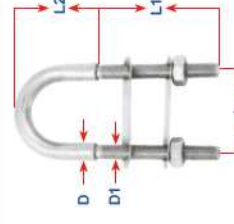

Tipo Type	D1 (mm)	D (mm)	L (mm)	L1 (mm)	L2 (mm)	€/Cad.
A	M 8	10	35	40	40	10 4,50
B	M 8	10	45	52	48	10 5,00
C	M 10	12	50	35	55	10 7,00
D	M 10	12	50	80	50	5 8,00
E	M 12	14	60	85	65	5 10,50

A2 / AISI 304

Art. n° 8267 Bullone con occhio
Eye bolt

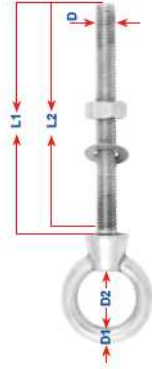

Tipo Type	D (mm)	L1 (mm)	L2 (mm)	D1 (mm)	D2 (mm)	Carico rottura Beaking load (Kgs ca.)	€/Cad.
A	M 6	60	54	5	15	1150	10 2,80
B	M 8	80	70	6	20	1300	10 4,50
C	M 10	100	88	8	25	1800	5 6,50
D	M 12	120	105	10	30	2500	2 10,00

A4 / AISI 316

Art. n° 8032 Golfare stampato lucido
Eye bolt, polished

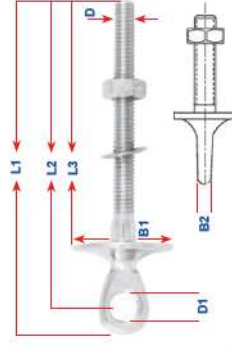

Tipo Type	D (mm)	L1 (mm)	L2 (mm)	L3 (mm)	B1 (mm)	B2 (mm)	D1 (mm)	Carico rottura Beaking load (Kgs ca.)	€/Cad.
A	M 6	83	76	60	25	4	6,5	1300	10 4,70
B	M 8	110	104	80	25	5	8,5	2400	10 5,90
C	M 10	137	125	100	30	6	10,5	3500	10 8,80

A2 / AISI 304

Eye bolts

Art. n° 8268 Golfare femmina
Eye nut



Tipo Type	D (mm)	B (mm)	W (mm)	H (mm)	Carico rottura Beaking load (Kgs ca.)	€/Cad.
A	M 6	28	16	31	1300	20 1,60
B	M 8	36	20	36	2200	20 2,30
C	M 10	45	25	45	2600	10 3,50
D	M 12	53	30	54	4900	10 5,50
E	M 16	62	35	63	7000	5 7,50
F	M 20	71	40	72	10000	2 11,00
G	M 24	90	50	90	18000	2 27,00

A4 / AISI 316

similar DIN 582

Art. n° 8364 Golfare maschio
Eye bolt

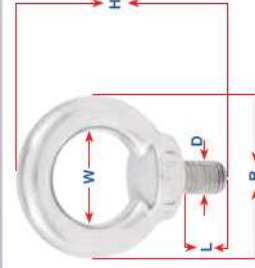

Tipo Type	D (mm)	B (mm)	L (mm)	W (mm)	H (mm)	Carico rottura Beaking load (Kgs ca.)	€/Cad.
A	M 6	28	12	15	31	1100	20 1,70
B	M 8	36	13	20	36	1800	20 2,50
C	M 10	45	17	25	45	2600	10 3,50
D	M 12	54	20,5	30	54	3500	10 5,50
E	M 16	63	27	35	63	8000	5 10,00
F	M 20	72	30	40	72	10500	2 13,00
G	M 24	90	36	50	90	14500	2 30,00

A4 / AISI 316

similar DIN 580

Art. n° 8228 Vite con anello
Eye bolt w. ring, assy.

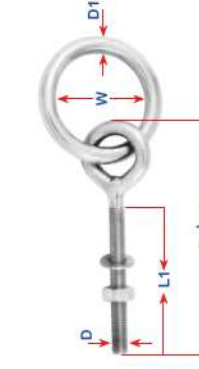

Tipo Type	D (mm)	D1 (mm)	L (mm)	L1 (mm)	W (mm)	Carico rottura Beaking load (Kgs ca.)	€/Cad.
A	M 6	6	90	55	35	1000	10 3,40
B	M 8	8	100	60	45	1800	10 5,20
C	M 10	9	130	80	50	2400	10 6,80
D	M 12	12	150	90	60	4000	10 12,00

A2 / AISI 304

Art. n° 8362 Vite a legno con anello
Wood screw w. ring, assy.



D1 (mm)	H (mm)	T (mm)	D2 (mm)	L (mm)	Carico rottura Beaking load (Kgs ca.)	€/Cad.
6	60	40	6	30	900	10 3,00
8	80	55	8	50	1500	10 4,00
10	100	65	10	60	2500	10 6,50
12	120	80	12	75	3500	10 12,00

A4 / AISI 316