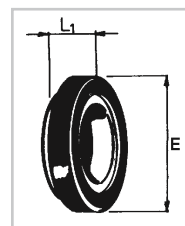
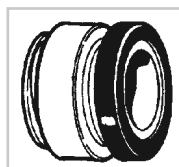
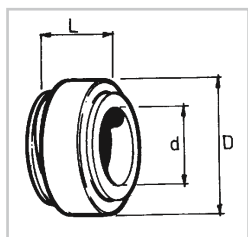

# TENUTE MECCANICHE

## MECHANICAL SEALS

Tenuta / Seal

Tenuta completa di controfaccia  
Seal complete with counterface

Controfaccia / Counterface

Articolo Art.	d Ø Albero d Ø Shaft	D	L Lung. lavoro L Working length
* T.49	8	18	11.5
T.50	8	24	11
T.52	10	24	11
T.47	11	24	11
* T.53	12	24	13
T.51	13	24	13
T.54	14	32	13
T.55	15	32	13
T.56	16	32	13
T.57	17	39	13
T.58	18	39	13
T.59	19	39	13
T.60	20	39	13
* T.61	22	42	13
T.62	23	47	14
T.63	24	47	14
T.64	25	47	14
T.65	28	54	15
T.66	30	54	15
T.67	32	54	15
T.68	35	60	16
T.69	38	65	18
T.70	40	65	18
T.71	45	70	20
T.72	50	85	23
T.73	60	105	30
T.74	65	105	30

Articolo Art.	d Ø Albero d Ø Shaft
T.49+C.19	8
T.50+C.20	8
T.52+C.20	10
T.47+C.20	11
T.53+C.20	12
T.51+C.21	13
T.51+C.21S	13
T.54+C.22	14
T.55+C.23	15
T.56+C.23	16
T.57+C.24	17
T.58+C.24	18
T.59+C.24	19
T.60+C.24	20
T.61+C.25	22
T.62+C.26	23
T.63+C.26	24
T.64+C.26	25
T.65+C.27	28
T.66+C.27	30
T.67+C.27	32
T.68+C.28	35
T.69+C.29	38
T.70+C.29	40
T.71+C.30	45
T.72+C.31	50
T.73+C.32	60
T.74+C.32	65

Articolo Art.	d Ø Foro d Ø Hole	E	L <sub>1</sub>
C.19	8	19	7.5
C.20	12	26	8
C.21	13	26	8
C.21S	13	26	5.5
C.22	16	35	8
C.23	16	38	8
C.24	21	42	8
C.25	23	45	10
C.26	27	50	10
C.26A	27	50	10
C.27	34	57	10
C.28	37	63	10
C.29	42	68	12
C.29A	42	68	12
C.30	47	73	12
C.31	52	88	15
C.32	67	110	15

\* Montata anche su pompe Sacemi

\* Suitable for Sacemi pumps

### PER POMPE PEDROLLO / FOR PEDROLLO PUMPS

Tenuta / Seal

Controfaccia / Counterface

Articolo Art.	d Ø Albero d Ø Shaft	D	L Lung. lavoro L Working length
T.45	14	28	13

Articolo Art.	d Ø Foro d Ø Hole	E	L <sub>1</sub>
C.15	15	28.5	7.5