



MVE 60/3

Three Phases - 2 poles - 3000 RPM - 50 Hz
230/400 Volt



Mechanical Features		Electric Features	
General		General	
Working Moment	1.31 kgcm	Nominal Voltage	Δ : 230 V Y : 400 V
Unbalance	0.66 kgcm	Input Power	0.08 kW
FC	66 kg	Current A Max	Δ : 0.28 A Y : 0.16 A
Bearings		Power factor	0.74
TYPE (SKF)	6202	la/ln	3
Life(h)	100% 39026	Certification	
	80%: 76223	ETL CLASS II DIV. II GROUP F, G TENV NEMA 4	T4
	50%: >100000	ATEX II 3D Ex tD A22 IP66	T 100°
Bearing Grease		Max Amb Temp.	40 °C
Lube Schedule (g)			
Lube Replacement (g)			
Grease Type			

Dimensional Features (mm)

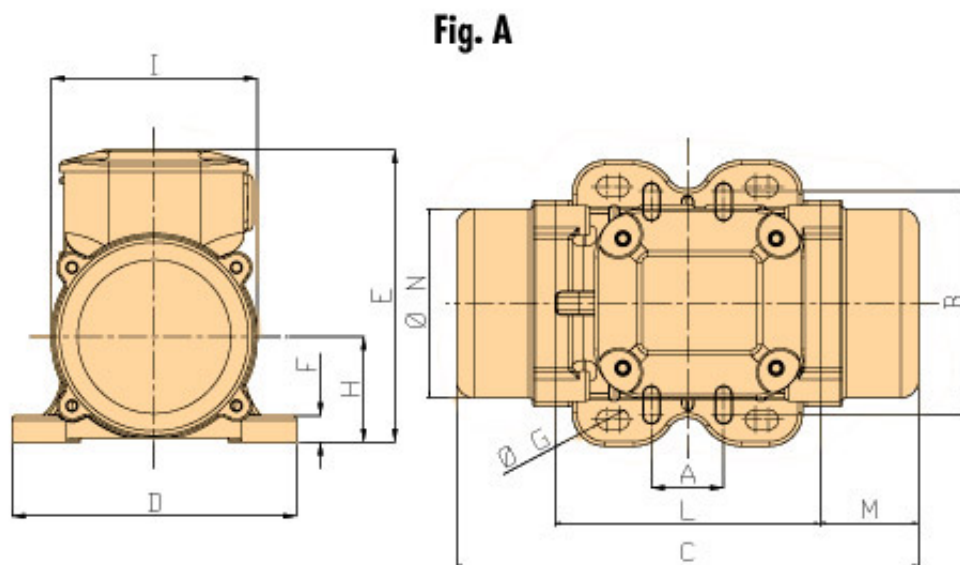

A	62-74 33
B	106 82- 102
G	9 7
C	211
M	45
holes	4 4
D	130

Clamping
Torque(Nm)

E **136**

23
9

[**Drawings Download**]

F **12**

H **48**

I **94**

L **121**

N **85**

Weight(kg)

Screw

Washer

Cable Type

Cable Glannde

4.2

M8
M6

8.4 x 16
6.4 x 12

4Gx1.5

M16

REV.0-01/10/2010