



# MVE 200/3

Three Phases - 2 poles - 3000 RPM - 50 Hz  
230/400 Volt



Mechanical Features		Electric Features	
<b>General</b>		<b>General</b>	
Working Moment	3.72 kgcm	Nominal Voltage	Δ : 230 V    Y : 400 V
Unbalance	1.86 kgcm	Input Power	0.18 kW
FC	187 kg	Current A Max	Δ : 0.61 A    Y : 0.35 A
<b>Bearings</b>		Power factor	0.78
TYPE (SKF)	6302	Ia/In	3,3
Life(h)	100% 5539	<b>Certification</b>	
	80%: 10818	ETL CLASS II DIV.II GROUP F,G TENV NEMA 4	T4
	50%: 44311	ATEX II 3D Ex tD A22 IP66	T 100°
<b>Bearing Grease</b>		Max Amb Temp.	40 °C
Lube Schedule (g)			
Lube Replacement (g)			
Grease Type			

## Dimensional Features (mm)

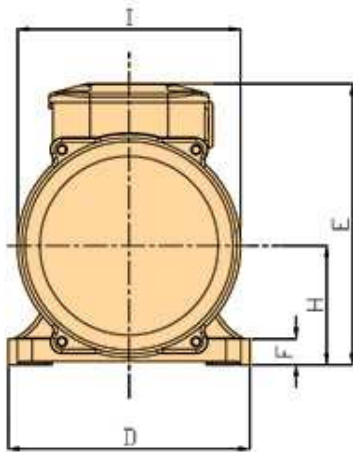
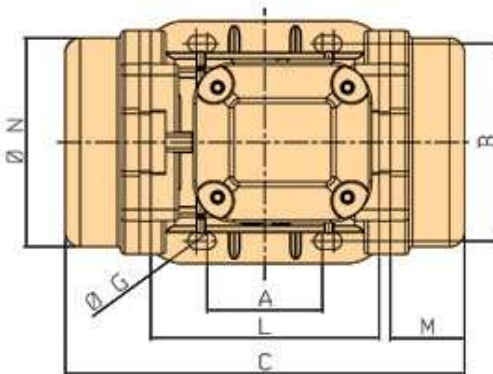

Fig. B



A	62-74
B	106
G	9
C	231
M	54
holes	4
D	131
E	159
F	15
H	64
I	121
L	123
N	112

Clamping Torque(Nm)

23

[ Drawings Download ]

Weight(kg)	Screw	Washer	Cable Type	Cable Glante
7	M8	8.4x16	4Gx2.5	M20

REV.0-01/10/2010